

**SUPORT TOPOGRAFIC**

Scara 1:500

**-INTRAVILAN-**

Adresa amplasament: Mun. Ploiesti, Str. Gheorghe Grigore Cantacuzino nr. 72-74, T 118, Cc 17, Cc 18, Jud. Prahova

Proprietari: FRUSINOIU BOGDAN SORIN

FRUSINOIU CARMEN ANTOANETA

Domiciliul: Mun. Ploiesti, Str. Veniamin Costache nr. 1, bl. 28B, et. 4, ap. 14, Jud. Prahova

Conform: Extras de carte funciara nr. 18260/09.02.2021

- NR. CAD. 140784

Certificat de urbanism nr. 234/01.03.2021

S(Din acte)= 576mp

S(Din masuratori)=591mp

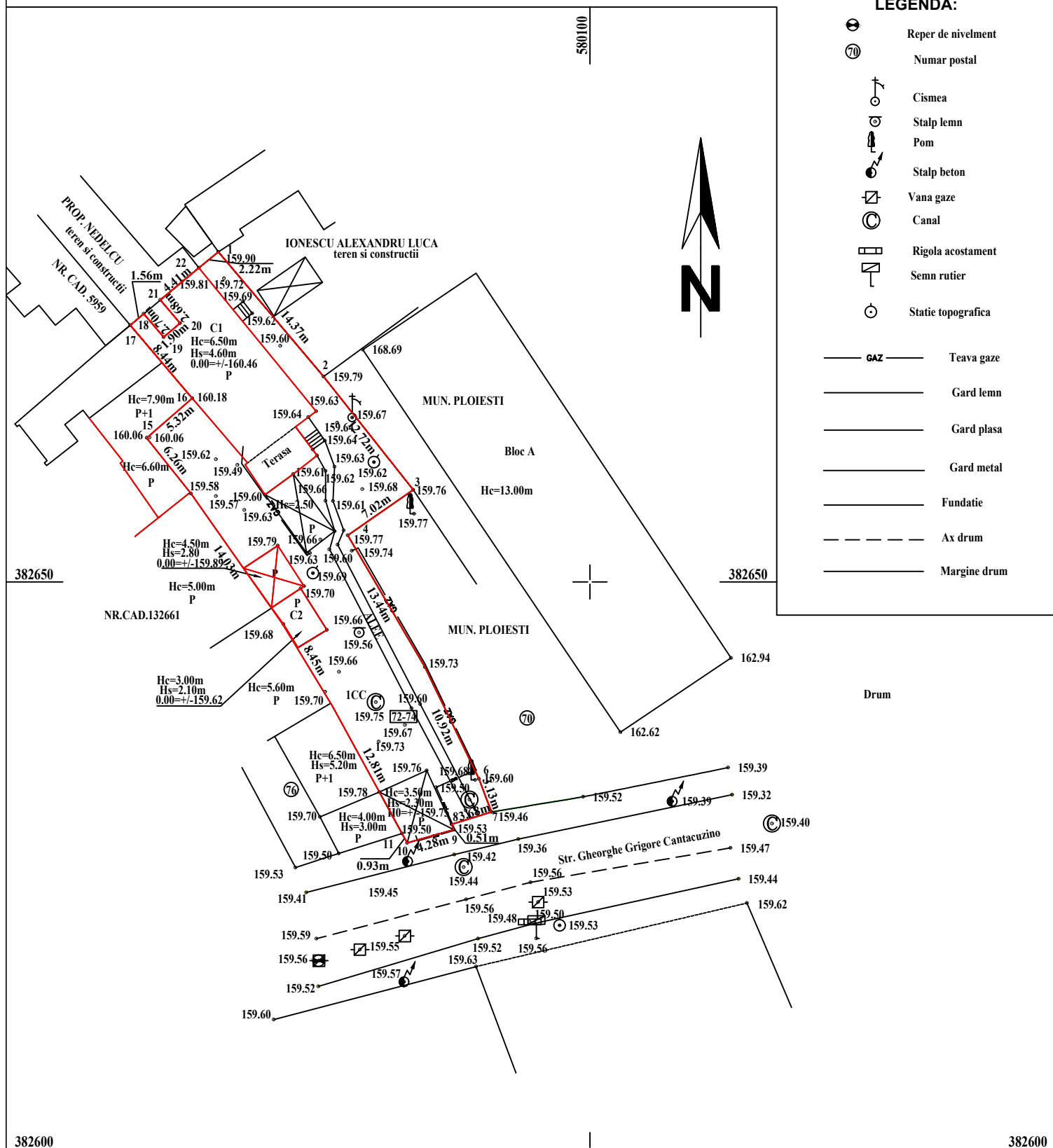
**LEGENDA:**

- Reper de nivel
- Numar postal
- Cisnea
- Stalp lemn
- Pom
- Stalp beton
- Vana gaze
- Canal
- Rigola acostament
- Semn rutier
- Statie topografica

- Teava gaze
- Gard lemn
- Gard plasa
- Gard metal
- Fundatie
- Ax drum
- Margine drum

Drum

VIZA O.C.P.I. PRAHOVA  
CONFORM LEGEA 50/1991 REPUBLICATA IN 2004

Data: Mai 2018

Scara: 1:500

Beneficiari  
FRUSINOIU BOGDAN SORIN  
FRUSINOIU CARMEN ANTOANETAPlanşa  
nr. 1  
UM  
(m)AUTORIZAT  
SOVA DAN CONSTANTIN  
Categorie A  
Seria RO-B-F Nr. 1977SUPPORT TOPOGRAFIC IN SCOPUL:  
"DEMOLARE C1 SI C2"